

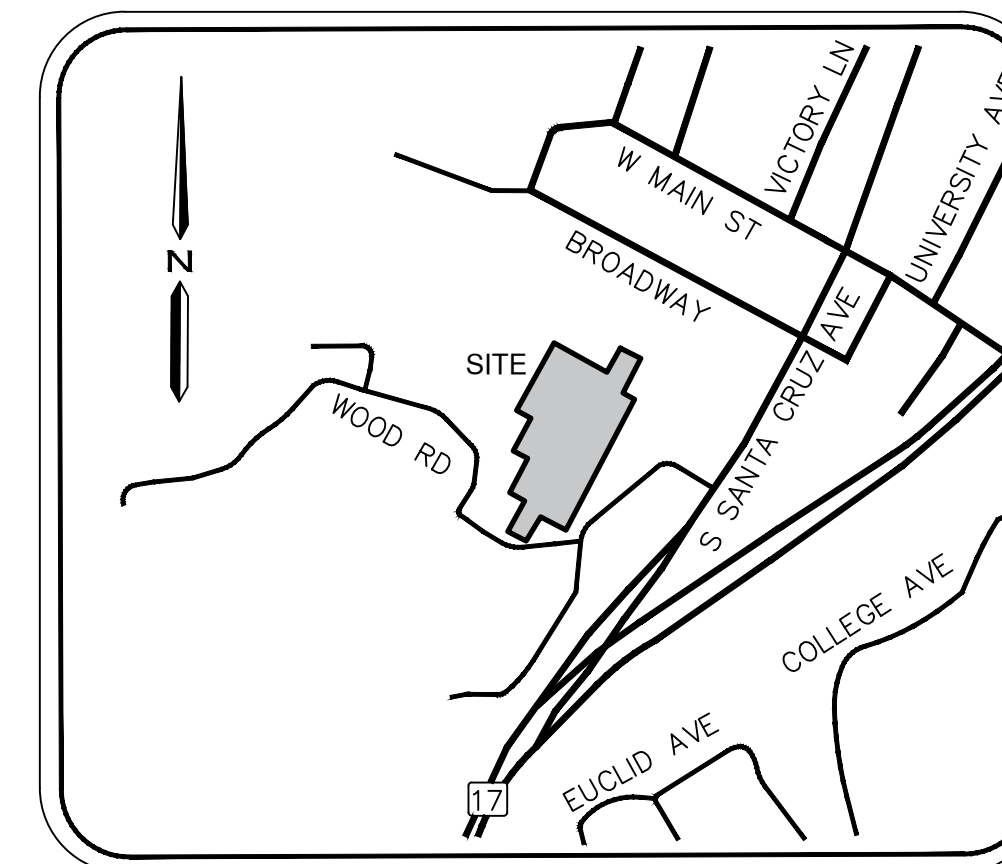

LOT MERGER MAP
PARCEL ONE AND PARCEL TWO OF DOCUMENT 25675910
110 WOOD ROAD

STATE OF CALIFORNIA

TOWN OF LOS GATOS



TOPOGRAPHIC LINE TYPES

MERGED PARCEL BOUNDARY
 PARCEL LINE TO BE REMOVED
 STREET RIGHT-OF-WAY
 CENTERLINE
 EASEMENT
 ADJOINING PROPERTY LINE

FENCE LINE - HEIGHT & TYPE NOTED

CURB AND GUTTER

STRIPING

WALL

BUILDING FOOTPRINT

CONCRETE

COPYRIGHT NOTE

COPYRIGHT © CHAPPELL GEOMATICS, INC. ALL RIGHTS RESERVED. NO PART OF THIS DRAWING MAY BE REPRODUCED BY PHOTOCOPYING, RECORDING OR BY ANY OTHER MEANS, OR STORED, PROCESSED OR TRANSMITTED IN OR BY ANY COMPUTER OR OTHER SYSTEMS WITHOUT THE PRIOR WRITTEN PERMISSION OF CHAPPELL GEOMATICS, INC. COPIES OF THIS DRAWING WITHOUT AN ORIGINAL SIGNATURE AND STAMP ARE NOT VALID.

TREE NOTE

TREE TYPES AND SIZE ARE FOR INFORMATIONAL PURPOSES ONLY. ACTUAL TYPE OF TREE, TREE SHAPE, AND GROVE CONFIGURATION MAY VARY FROM ACTUAL FIELD CONDITIONS. NO WARRANTIES ARE IMPLIED WITH REGARD TO TREE INFORMATION.

REFERENCED TITLE REPORT

THIS SURVEY WAS PREPARED FROM INFORMATION FURNISHED IN THE BELOW REFERENCED PRELIMINARY TITLE REPORT. NO LIABILITY IS ASSUMED FOR MATTERS OF RECORD NOT STATED IN SAID PRELIMINARY REPORT THAT MAY AFFECT THE TITLE LINES, OR EXCEPTIONS, OR EASEMENTS OF THE PROPERTY.

TITLE COMPANY: FIRST AMERICAN TITLE COMPANY
333 W. SANTA CLARA STREET
STE 220
SAN JOSE, CA 95113

ORDER NO: NCS-1021510-1 SC
ASSESSOR'S PARCEL NO.: 510-47-038

TOPOGRAPHIC SURVEY NOTES

1. ALL DISTANCES SHOWN HEREON ARE IN FEET AND DECIMALS THEREOF.
2. PHYSICAL ITEMS SHOWN ON THIS SURVEY ARE LIMITED TO THOSE SURFACE ITEMS VISIBLE AS OF THE DATE OF THIS SURVEY. SUBSURFACE OBJECTS NOT SHOWN MAY BE, BUT ARE NOT LIMITED TO, CONCRETE FOOTINGS, SLABS, SHORING, STRUCTURAL PILES, UTILITY VAULTS, PIPING, UNDERGROUND TANKS, AND ANY OTHER SUBSURFACE STRUCTURES NOT REVEALED BY A SURFACE INSPECTION OR PER SITE IMPROVEMENT PLANS.
3. DIMENSIONAL TIES TO IMPROVEMENTS ARE 90° TO THE PROPERTY LINES UNLESS NOTED OTHERWISE
4. THE FIELD DATA FOR THIS SURVEY WAS COLLECTED USING A TRIMBLE TOTAL STATION.

BASIS OF BEARINGS

THE BASIS OF BEARINGS FOR THIS SURVEY IS THE CALIFORNIA COORDINATE SYSTEM, ZONE 3. NAD 83 (EPOCH 2009.0) AS SHOWN ON THE RECORD OF SURVEY FILED IN BOOK 846 OF MAPS, PAGE 38, SANTA CLARA COUNTY RECORDS.

LOT MERGER NOTES

1. NO BUILDING SETBACKS WILL AFFECT THIS MERGER OF THESE TWO PARCELS
2. TREES WERE NOT LOCATED ON THE WESTERLY PORTION OF THIS PARCEL SINCE THEY DO NOT AFFECT THIS MERGER

SURVEYOR'S STATEMENT

THIS MAP WAS PREPARED BY ME OR UNDER MY DIRECTION.

Brett Chappell
BRETT J. CHAPPELL, PROFESSIONAL LAND SURVEYOR
LICENSE NUMBER 7547
EXPIRATION DATE: DECEMBER 31, 2025

8/27/2025
DATE

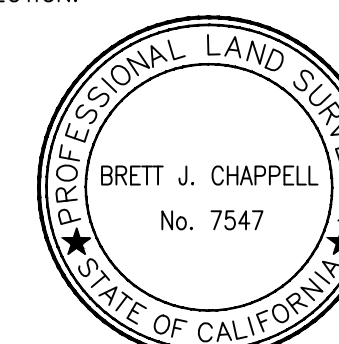

Date	8/27/2025	No.	Revisions
Scale	1"=50'		
Field	WI		
Mapping	B/C		
Approved	B/C		
Job No	2025044		

Drawing:
2025044MERGE